

TABLE OF SERVICE LOCATIONS

Table with 9 columns: STREET NAME, SEWER, WATER, NDW, GAS, COMMS, ELEC, \*POLES, BOK. Rows include WATTLE CRESCENT, RIBBONGUM WAY, WATTLEVIEW PL., and KENILWORTH AVE.

\* FROM BACK OF KERB

TBM SCHEDULE

Table with 4 columns: I.D., TYPE, EASTING, NORTHING, LEVEL. Rows include TBM 1 through TBM 7 with details like SPIKE, STEEL ROD, and their respective coordinates and levels.

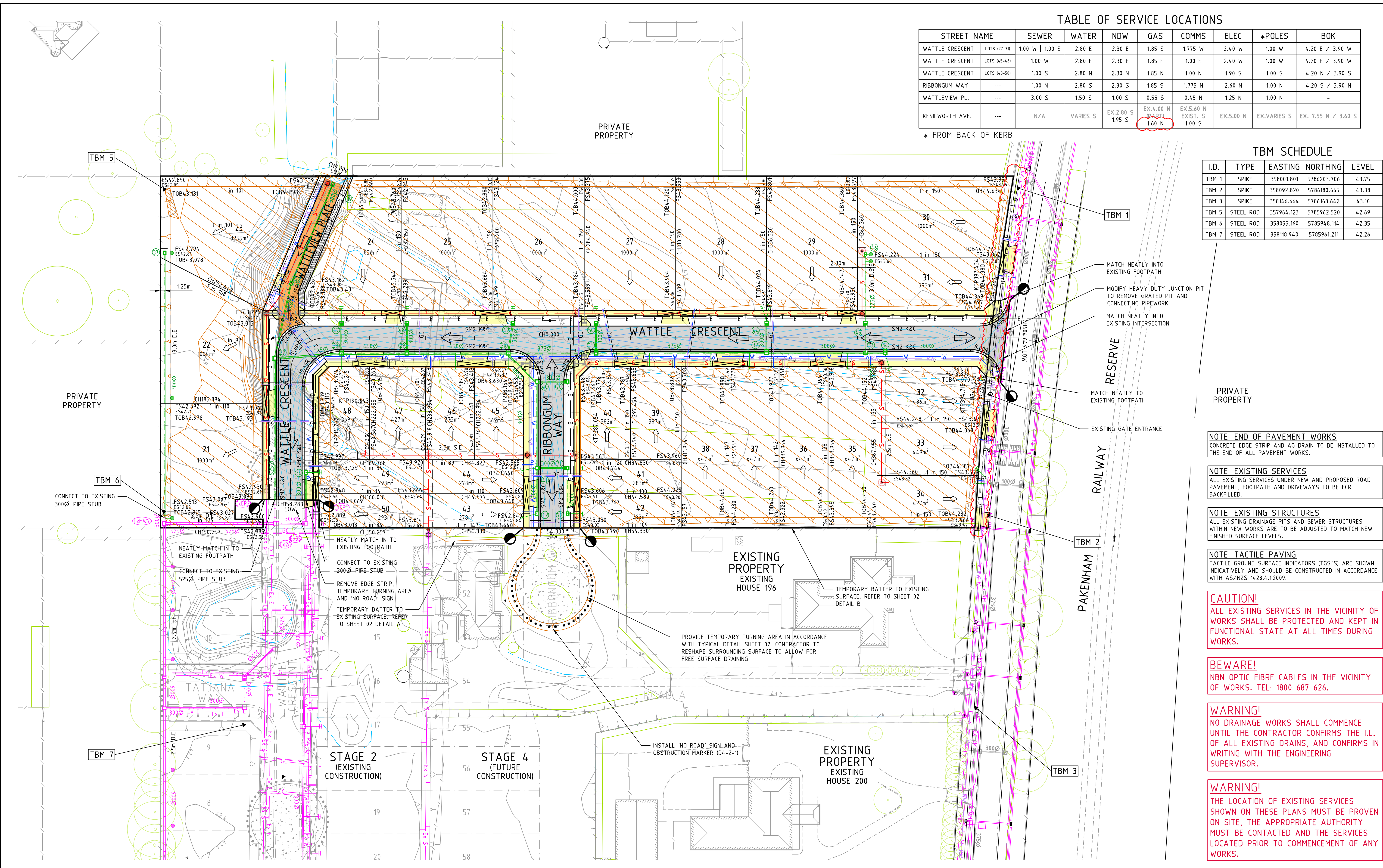

NOTE: END OF PAVEMENT WORKS. CONCRETE EDGE STRIP AND AG DRAIN TO BE INSTALLED TO THE END OF ALL PAVEMENT WORKS.

NOTE: EXISTING SERVICES. ALL EXISTING SERVICES UNDER NEW AND PROPOSED ROAD PAVEMENT, FOOTPATH AND DRIVEWAYS TO BE FCR BACKFILLED.

NOTE: EXISTING STRUCTURES. ALL EXISTING DRAINAGE PITS AND SEWER STRUCTURES WITHIN NEW WORKS ARE TO BE ADJUSTED TO MATCH NEW FINISHED SURFACE LEVELS.

NOTE: TACTILE PAVING. TACTILE GROUND SURFACE INDICATORS (TGS/IS) ARE SHOWN INDICATIVELY AND SHOULD BE CONSTRUCTED IN ACCORDANCE WITH AS/NZS 1428.4.1:2009.

CAUTION! ALL EXISTING SERVICES IN THE VICINITY OF WORKS SHALL BE PROTECTED AND KEPT IN FUNCTIONAL STATE AT ALL TIMES DURING WORKS.

BEWARE! NBN OPTIC FIBRE CABLES IN THE VICINITY OF WORKS. TEL: 1800 687 626.

WARNING! NO DRAINAGE WORKS SHALL COMMENCE UNTIL THE CONTRACTOR CONFIRMS THE I.L. OF ALL EXISTING DRAINS, AND CONFIRMS IN WRITING WITH THE ENGINEERING SUPERVISOR.

WARNING! THE LOCATION OF EXISTING SERVICES SHOWN ON THESE PLANS MUST BE PROVEN ON SITE, THE APPROPRIATE AUTHORITY MUST BE CONTACTED AND THE SERVICES LOCATED PRIOR TO COMMENCEMENT OF ANY WORKS.

Vertical text on the left margin containing drawing metadata and revision details.

Table with 4 columns: REV, DESCRIPTION, DATE, AMEND, APP'D. It lists revisions such as 'KENILWORTH GAS AND SERVICE OFFSET TABLE AMENDED' and 'CONSTRUCTION ISSUE'.

Drawn: H.MINA, Date: 25/03/21, AN 3581036. Designed: C.BLISSETT, Date: 01/04/21, AN 2771030. Checked: J.BURNS, Date: 21/04/21, AN 1631663. Approved: T.LIAKOPoulos, Date: 15/07/21, AN 889105.

LEGEND section containing symbols and line styles for various utilities: EX. WATER MAIN, EX. GAS MAIN, EX. ELECTRICAL CABLE, EX. SEWER MAIN & MH, EX. COMM. CABLE & PIT, EX. DRAIN & PIT, SIGNAGE, PSM | TBM, ELECTRICITY, TELECOMMUNICATIONS, GAS, WATER, RECYCLED WATER, DW/NDW/GAS CONDUITS, LIMIT OF WORKS, OVERLAND FLOW PATH, SEWER MAIN & MANHOLE, SW DRAIN & PIT, HOUSE DRN | PROP. INLET, BATTERY, FINISHED SURFACE LEVEL, EX. SURFACE LEVEL, TOP OF BATTER LEVEL, REGRADE LOT (M 1:50), EX. TREE TO REMAIN, FILLING OVER 200mm, ASPHALT PAVEMENT, CONCRETE PATH | D'WAY, HEAVY DUTY CONCRETE D'WAY.

BANRIAR INVESTMENTS logo and title block. Includes 'BEFORE YOU DIG' logo with website www.byda.com.au, 'Coors: MGA Levels: AHD', and scale information: Scale @ A1/A3, 1:500 / 1:1000.

BEAconsfield WATTLE ESTATE STAGE 3 190 KENILWORTH AVENUE, BEAconsFIELD CARDINIA SHIRE COUNCIL DETAIL PLAN Drawing No. 18144.3DP01 Rev 1 Sheet No. 05 of 27

DALTON CONSULTING ENGINEERS logo and contact information: VICTORIA T 61 3 9813 7400 W dceng.com.au; QUEENSLAND T 61 7 3374 9000 E info@dceng.com.au. A large 'CONSTRUCTION' banner is at the bottom.